

Visible Light Sensing Photo Diode(a-Si) KVS-1001-P1

Description

The KVS-1001-P1 is high sensitive visible light sensor which KVS-1001(a-Si) and zenor diode combined in one PCB.
ESD is improved remarkably, minium 10kV for HBM.

Features

- High Sensitivity in a visible area, but little Sensitivity in Others (UV and IR)
- Environment friendly Product (not contain Cadmium)
- Improved ESD Minium 10kV for HBM

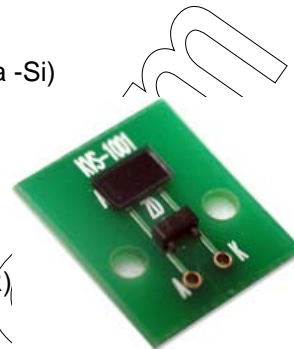

Outline Dimensions

unit = mm

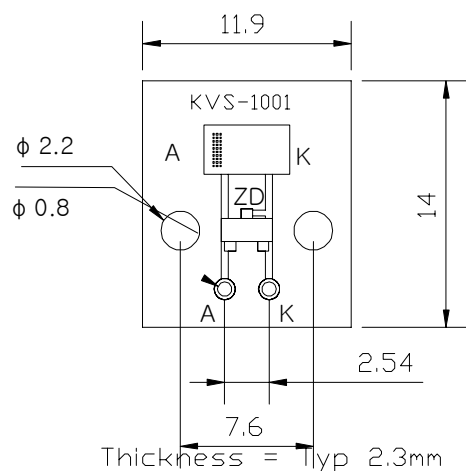

Application

- Brightness Detection of CRT, LCD
- Beam Position Detection of Projection TV
- Replace for CdS cell
- Control of the Lighting in a Car, Room, etc

Spectral sensitivity

Relative intensity Vs. Wavelength

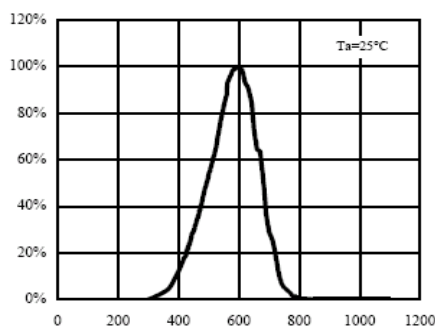

Characteristics

[Ta= 25 °C]

Description	Symbol	Condition	Min.	Typ.	Max.	Unit
Open circuit voltage	Voc	Ev= FL 100lx ^{*1}	0.35	0.40	-	V
Short circuit current	Ish		0.35	0.39	-	uA
Dark current	ID	VR=1V	-	0.5	5	nA
Spectral sensitivity	λ	5 ~ 10%	350~750			nm
Peak Wavelength	λ_p		-	590	-	nm

*1. Normal White Fluorescent Light