

型号	频率 (KHz)	灵敏度 (0dB=v/Pa)	输出声压 (at10v,30cm) (0dB=0.02MPa)(min)	静电电容 (±30%PF)	余振时间 (ms)max
TCF40-16TR1	40	-67	100	2000	0.5

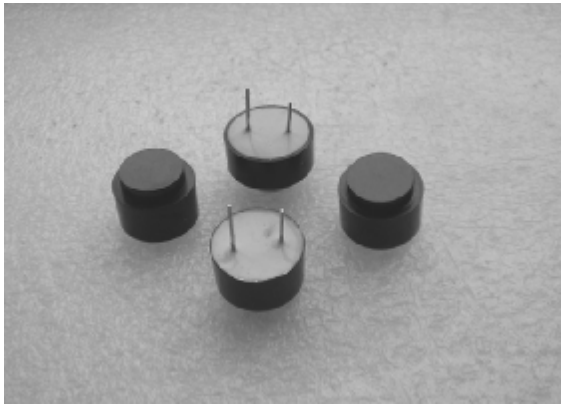
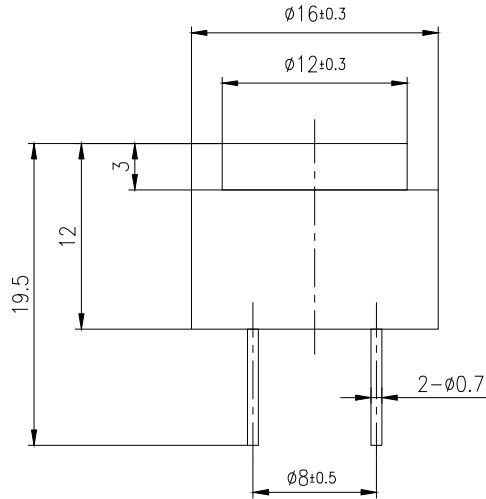

SIPAT Co., Ltd.
(CETC No.26 Research Institute)
#14 Nanping Huayuan Road,
Chongqing, China, 400060