



Pressure Sensor

HPD Series

Our pressure sensors are fabricated with an advanced semiconductor micromachining process, to meet a variety of customer requirements. The high sensitive and high precision sensor is available for any applications.

■ Features

- Low expansion ceramic package for high precision and reliability.
- Small in size, low in price
- Surface mountable, leadless construction
- Low power consumption

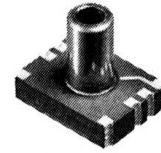

Gauge Type

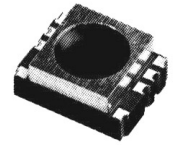

Absolute Type

■ Construction

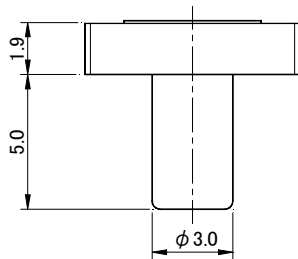
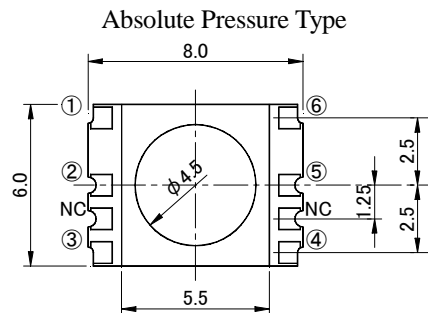
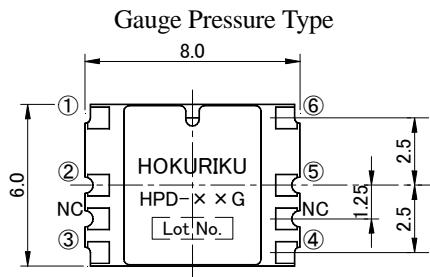

Terminal

①	+INPUT
②	-OUTPUT
③	-INPUT
④	-INPUT
⑤	+OUTPUT
⑥	+INPUT

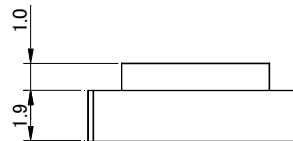

Terminal

①	+INPUT
②	+OUTPUT
③	-INPUT
④	-INPUT
⑤	-OUTPUT
⑥	+INPUT

※Pressure guide port available

■ Specifications

Item	Rating	Unit	Note
Max. Rating			
Pressure	2 times of rated pressure (For 1000kPa, 1.5 times)	kPa	
Drive Current	1	mA	A fixed voltage drive can cope with it, too.
Operating Temperature Range	-30~85	°C	
Storage Temperature Range	-40~100	°C	
Operating Condition			
Pressure Range	±50, ±100, ±500, ±1000	kPa	
Drive Current	0.5	mA	A fixed voltage drive can cope with it, too.
Pressure Medium	Non-corrosive Gas		
Type of Pressure	Gauge or Absolute		
Electrical Performance (Ta=25°C, Icc=0.5mA)			
Offset Voltage	±10	mV	
Span Voltage	±40~±100	mV	FS=0 to Max.pressure.
Bridge Resistance	7000~10000	Ω	
Pressure and Linearity	±0.3 (For 1000kPa, ±1.0)	%FS	FS=0 to Max.pressure.
Pressure and Hysteresis	±0.7	%FS	FS=0 to Max.pressure.
Offset Temperature Characteristics	±5	%FS	FS=0 to Max.pressure.
Span Temperature characteristics	±2.5	%FS	Temperature characteristics are for 0~50°C.

※ Customer specifications are acceptable.

■ Type Designation

HPD - 50 G (- S01)

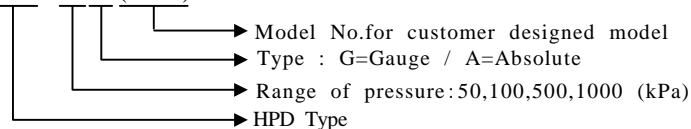



Pressure Sensor

HPM Series

New

■ Features

- High precision HPD sensor is applied
- Leadless for high density mounting
- Flexible circuit design

■ Construction

Gauge Pressure Type

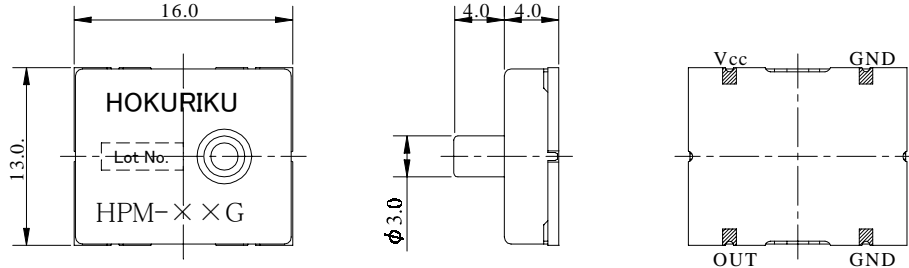

Gauge Type

Absolute Type

Absolute Pressure Type

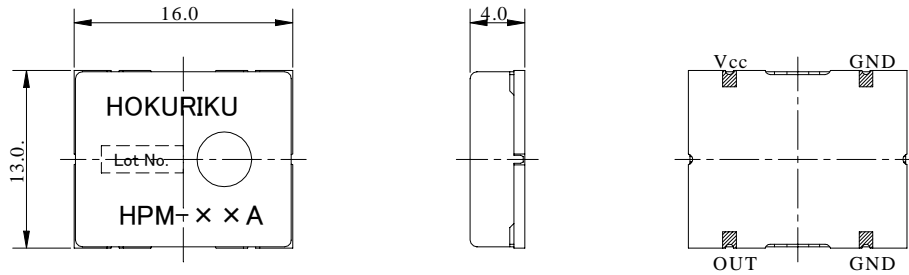

※ Pressure guide port available

■ Specifications

Item	Rating	Unit	Note
Max.Rating			
Pressure	2 times of rated pressure (For 1000kPa.1.5 times)	kPa	
Drive Voltage	7.0	VDC	
Operating Temperature Range	-30~85	°C	
Storage Temperature Range	-40~100	°C	
Operating Condition			
Pressure Range	±50, ±100, ±500, ±1000	kPa	
Drive Voltage	5.0	VDC	
Pressure Medium	Non-corrosive Gas		
Type of Pressure	Gauge or Absolute		
Electrical Performance (Ta=25°C Vcc=5.0VDC)			
Current Consumption	Max. 10	mA	
Zero Cross Output Voltage	0.3±0.1	VDC	
Max.Output Voltage	Max. 4.7	VDC	
Span Voltage	4.0 TYP.	VDC	FS=0 to Max.pressure.
Output Accuracy	±5	%FS	FS=0 to Max.pressure. Temperature characteristics are for 0~50°C

※ Customer specifications are acceptable.

■ Type Designation

HPM - 50 G (- S01)

